

Cavity wall lintels - Standard duty

CA19 range

CA19 Lintels are standard duty but deep in section. They are versatile lintels ideal for carrying similar loads to the CA12 and the CA16 range lintels but over longer spans.

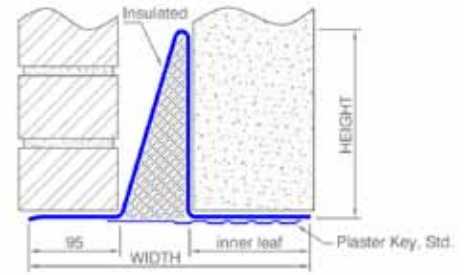

Need a stronger lintel? See CA20 >

Specification table for CA19 Lintels

Nominal cavity size (mm)	Nominal inner leaf (mm)	SPECIFY	Overall Height (mm)	Overall Width (mm)	Steel Gauge (mm)	Mass (kg/m)	Form Type	Ixx (cm ⁴)	Zxx (cm ³)
	100-115	CA19-100/50/100	211	242	2.0	9.6	1	621.7	45.38
47-56	125-140	CA19-100/50/125	198	268	2.0	9.6	1	548.4	41.23
	190-215	CA19-100/50/190	200	333	2.0	13.3	2	698.8	46.28
	100-115	CA19-100/60/100	210	253	2.0	9.6	1	617.0	45.04
57-71	125-140	CA19-100/60/125	197	278	2.0	9.6	1	542.6	41.11
	190-215	CA19-100/60/190	199	342	2.0	13.5	2	698.2	46.24
	100-115	CA19-100/75/100	208	267	2.0	9.6	1	604.1	44.75
72-84	125-140	CA19-100/75/125	195	293	2.0	9.6	1	531.2	40.55
	190-215	CA19-100/75/190	197	358	2.0	13.7	2	688.1	45.87
	100-115	CA19-100/90/100	208	277	2.0	9.6	1	603.4	44.70
85-96	125-140	CA19-100/90/125	193	305	2.0	9.6	1	519.7	40.29
	190-215	CA19-100/90/190	195	370	2.0	14.0	2	681.9	45.77
	100-115	CA19-100/100/100	205	290	2.0	9.6	1	585.8	44.05
97-119	125-140	CA19-100/100/125	191	316	2.0	9.6	1	508.8	39.75
	190-215	CA19-100/100/190	193	382	2.0	14.1	2	672.0	45.41
	100-115	CA19-100/120/100	197	313	2.0	9.6	3	543.9	43.17
120-139	125-140	CA19-100/120/125	197	338	2.0	10.0	3	567.5	43.99
	190-215	CA19-100/120/190	199	403	2.0	14.8	4	768.0	50.86
	100-115	CA19-100/140/100	201	333	2.0	10.0	3	584.3	46.01
140-160	125-140	CA19-100/140/125	201	358	2.0	10.3	3	609.7	46.90
	190-215	CA19-100/140/190	203	423	2.0	15.4	4	836.2	54.30

NOTES: The form varies over the range to maintain load capacity, see below opposite page. CA17&18 lintels types 3 & 4 require a separate DPC, but types 1 & 2 do not and are supplied with stop-ends* (see p78 & p88 for details).

Allowable load for all CA19 Lintels*

Opening Span	Lintel Length	Max total load (kN)*	Load Example (see pg 85)
450	750	42.0	masonry & timber floor
600	900	42.0	
750	1050	42.0	
900	1200	42.0	
1050	1350	42.0	
1200	1500	42.0	
1350	1650	42.0	
1500	1800	42.0	
1650	1950	42.0	
1800	2100	38.8	
1950	2250	36.0	full height masonry
2100	2400	33.6	
2250	2550	31.5	
2400	2700	29.6	
2550	2850	28.0	
2700	3000	26.5	
2850	3150	25.2	
3000	3300	24.0	
3150	3450	21.9	
3300	3600	19.9	
3450	3750	18.2	
3600	3900	16.8	
3750	4050	15.4	
3900	4200	14.3	

Intermediate sizes can be produced

Permissible Moment*: 9.4 kN.m
Permissible Point Load*: 5.8 kN

LOAD RATIO LIMITS* (OUTER : INNER)
65-100% Max load: 1:1 - 1:3 OR < 65% Max Load: 2:1 - 1:5

*See page 78 for loading & Installation guide

SPECIFYING OPTIONS FOR CA-TYPE LINTELS.

The specification convention for CA lintels is shown to the right with an example.

Should you require something different from the standard lintels listed in the tables, the specification components in blue can be varied to achieve non standard dimensions and features; such as a stepped outer, flat base (no plaster key), or shorter or longer inner and outer leaf supports as shown in the example to the right. Most imaginable variations can be manufactured, and the lead time is often the same as for standard lintels

